

SSR[®] 三叶罗茨鼓风机

THREE(3)LOBE ROTARY BLOWER



SSR[®]

山东章晃机械工业有限公司

SHANDONG ZHANGHUANG MACHINERY INDUSTRY CO.,LTD.

地址: 山东省章丘市相公庄镇

Add: Xiangong zhuang Town, Zhangqiu City, Shandong Province, China.

电话: 0531-83831641 (总机)

Tel: 0531-83831641

传真: 0531-83831640

Fax: 0531-83831640

电子信箱: sales@zhanghuang.com

E-mail: sales@zhanghuang.com

网址: www.zhanghuang.com

Http://www.zhanghuang.com

邮编: 250203

Postcode: 250203

代理店 (Agent)

本样本所记录的内容有因技术改进而变更的可能性, 不另行通知, 请予谅解。
It should be that we reserve the right to change the contents of this catalogue without prior notice.

中日合资 山东章晃机械工业有限公司
SHANDONG ZHANGHUANG MACHINERY INDUSTRY CO.,LTD.

中国·济南

新的发明，新的技术，创造美好的明天

ZHANGHUANG MACHINERY INDUSTRY CO.,LTD
is creating the tomorrow with a newconcept

山东章晃机械工业有限公司简介

山东章晃机械工业有限公司是由山东省章丘鼓风机厂和日本大晃机械工业株式会社、世晃产业株式会社共同投资创办的中日合资企业。

山东章晃机械工业有限公司(以下简称合营公司)是在机械工业部、中国通用机械工程总公司和各级政府主管部门关心与支持下成立的。

合营公司现累计总投资 626 万美元,注册资金 446 万美元,其中中方投资占 40%,日方投资占 60%。

主要产品 SSR 系列罗茨鼓风机,是日本大晃机械工业株式会社新开发的三叶型罗茨鼓风机,其流量 0.6m³/min-56m³/min, 升压 9.8kPa-78.4kPa, 共 8 个机型,80 种规格,该风机的显著特点是体积小、重量轻、流量大、噪声低、运行平稳可靠。该风机主要用于水处理、气力输送、真空包装、水产养殖等行业。

公司按照质量第一、用户满意的指导方针进行生产和经营,于 1997 年 12 月正式通过了中国进出口商品质量认证中心的评审,建立了自己符合 ISO9001 设计、开发、生产、安装和服务的质量保证模式的质量保证体系。自 1996 年投产以来,以其合理的价格,可靠的质量和完善的服务,迅速得到了广大客户的信赖和认可。目前,产品已经在全国水处理行业、粮食食品加工行业占有绝对优势,市场覆盖率 85% 以上,产品源源不断地销往全国各地。

SHANDONG ZHANGHUANG MACHINERY INDUSTRY CO.,LTD is a China-Japan joint venture invested by SHANDONG PROVINCE ZHANGQIU BLOWER WORKS,TAIKO KIKAI INDUSTRIES CO.,LTD and SECOH INDUSTRIES CO.,LTD.

SHANDONG ZHANGHUANG MACHINERY INDUSTRY CO.,LTD is established depending on the support from China Machinery Industry Ministry,China National General Machinery Engineering corp.and from government responsible department at different levels.

The joint venture now has accumulative total investment of USD 6,260,000,registered capital of USD 4,460,000. The investment proportion of China is 40%,proportion of Japan is 60%.

The main products Type SSR Blowers are new three-lobe roots blowers developed by TAIKO KIKAI INDUSTRIES CO.,LTD. The blowers flow capacity is from 0.6m³/min to 56m³/min,pressure rise is from 9.8kPa to78.4kPa.The three-lobe Type Roots Blowers have 8 models,80 specifications,their remarkable features are little outline,light weight, full flow capacity,low noise and reliable operation. The products are mainly used in sewage treatment,pneumatic systems,vacuum packing and aquatic farming.

The corporation follows the policy of quality first and making user satisfaction to produce and manage has established quality guarantee system of design,development,assembling and service according to ISO9001 and passed the evaluation of China Quality certification Center For Import And Export Commodities in December,1997.Since 1996,the products have got user's trust because of its reasonable price,reliable quality and good service.At present,our products have the absolute predominance in sewage treatment,foodstuff with a market share of 85%. Our products are being saled in China.



SSR

口径 $\phi 50 \sim \phi 200\text{mm}$
流量 1.22 ~ 60m³/min
压力 9.8kPa ~ 80kPa

SSR-V

口径 $\phi 50 \sim \phi 200\text{mm}$
流量 0.86 ~ 60m³/min
压力大气压 ~ -39.2kPa

P6-P13



SSR-HB

口径 $\phi 50 \sim \phi 200\text{mm}$
流量 1.24 ~ 60m³/min
压力 9.8kPa ~ 78.4kPa

SSR-VHB

口径 $\phi 50 \sim \phi 200\text{mm}$
流量 0.86 ~ 60m³/min
压力大气压 ~ -44kPa

P14-P22



SSR-HB-U

口径 $\phi 50 \sim \phi 200\text{mm}$
流量 1.24 ~ 60m³/min
压力 9.8kPa ~ 78.4kPa

P23-P25



SSR-T

口径 $\phi 20 \sim \phi 50\text{mm}$
流量 0.1 ~ 2.01m³/min
压力 9.8kPa ~ 49kPa

SSR-VT

口径 $\phi 20 \sim \phi 50\text{mm}$
流量 0.1 ~ 2.35m³/min
压力大气压 ~ -34.3kPa

P26-P28

>>章晃罗茨鼓风机的特点

>>ZHANGHUANG ROOTS TYPE ROTARY BLOWERS FEATURES

■ 螺旋形状是 20° 以上的固定螺旋方式。机壳的进排风屏蔽线切入螺旋，以转子顶端光面线构成的三角形进排风口，通过转子的旋转而循序打开。

■ 本风机的进排风口，不像旧式罗茨螺旋风机那样在瞬间打开或关闭，所以运转声音极小，几乎没有排风脉动。

■ 因为转子是三叶直线形，所以它不像螺旋式转子那样，因轴向微小变位而使转子相互接触。因此，只在剖面上保证转子间的间隙即可，不需要像转子螺旋式那样再加上轴向变位，以致间隙过大。这种风机的效率比相同尺寸的转子螺旋式风机好得多。

■ 因转子采取特殊外形，便于保持转子间的相互间隙，使效率进一步提高。

■ 因使用精密数控机床批量生产转子，并对精度管理采取了完善的措施，所以，各台风机之间完全没有性能误差。另外，转子在制造过程中已成平衡状态。所以，转子不会像过去那样残留微小的不平衡。本机几乎完全没有振动。

■ 采用最高级驱动齿轮，不仅使寿命得到延长，而且实现了低噪音化。该齿轮采用特殊 Cr-Mo 钢经适当淬火处理，严格按照 JISI 级齿轮精度精研削制造。因而来自齿轮对产品的不良干扰完全排除。

■ 输出空气清洁，不含任何油质灰尘。机壳内部不须油类润滑，且采用了避免轴承，齿轮油类混入机壳内部的结构设计。

■ 随着公司品质管理、生产管理体制的确立，实现了部件相互交流、低生产成本、短期交货的目标。该风机一般情况下，有适量库存。可以实现当即供货。

■ The helical construction uses the stator helical method that the screen lines of casing at the suction and discharge sides are cut to a helical shape, and the triangle suction and discharge port formed by a straight line of the rotor top is to be opened and closed gradually.

■ Therefore, the suction and discharge ports of this type is not opened or closed at moments, which makes these blowers have an only limited operation sound and almost free from pulsations from discharge.

■ The rotors are three-lobe straight type, so that the rotors can not interfere with each other, resulting from minor displacements in the thrust direction as in the helical type. Therefore, the clearance between the rotors should be assured in the profile direction only and thus there is no necessity of an excessive clearance on account of displacements in the thrust direction as in case of the rotor helical type. From such reasons, these blowers have a very high efficiency, in comparison with the rotor helical type of same dimensions.

■ By adoption of a unique profile of rotor, the clearance between the rotors can be held to be constant, which makes the efficiency even higher.

■ The precision of rotors is fully controlled and variation of precision between blowers is almost nil because the rotors are produced under the mass production control by utilizing a precision NC machining. In addition, the rotors are dynamically balanced in the fabrication stage already, so that these rotors are almost free from vibrations as in the case of conventional rotors which are still unbalanced.

■ The advancedest driving gears are adopted not only to extend the use life but also to make noise lower. The gears are made in special Cr-Mo steel by hardening treatment and are made according with gear precision of JISI first-class. Therefore, the harmful disturbances to products from gears are avoided.

■ The transported air is clean and is any oil-dust free oil lubrication is not needed in casing and the structure design prevent the bearing oil and gear oil from entering the casing.

■ With the establishment of quality management system and manufacture management system, the aims of parts exchanging, less production cost and rapid delivery are realized. The blowers of right quantity are kept in stock to make delivery in time.

>>用途举例

>>APPLICATION EXAMPLES

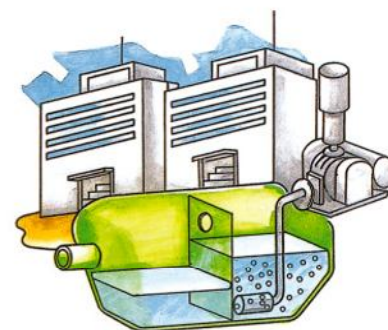

■ 公寓大楼的污水处理 (曝气)
Waste water Aeration in Condominiums



■ 工厂废水和畜产废水处理 (曝气)
Waste Water Aeration for Shops and Livestock Industries



■ 养鱼用 Fish Care



■ 水泡浴 Foaming in Bath



■ 燃烧炉
Combustion a Fireplace

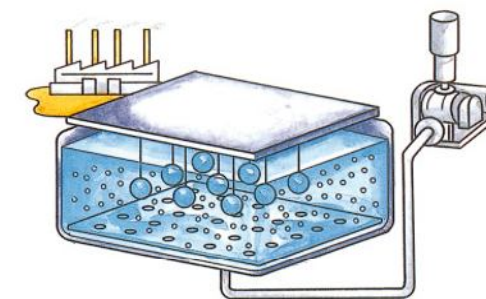

■ 电镀槽搅拌
Stirring in Plated Vessel

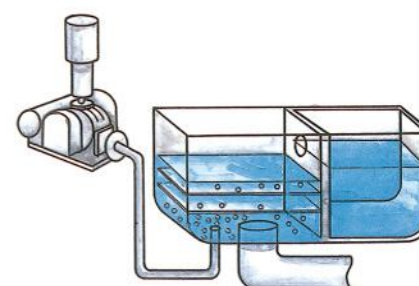

■ 冲洗 Back Washing

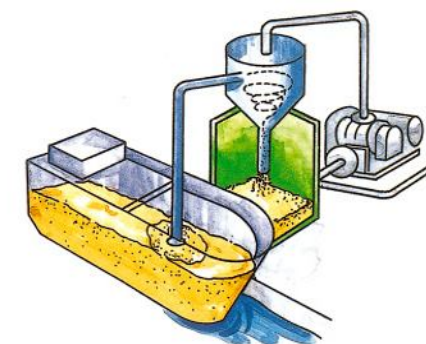

■ 粉体输送 (水泥、饲料、小片状物)
Transport of Particles

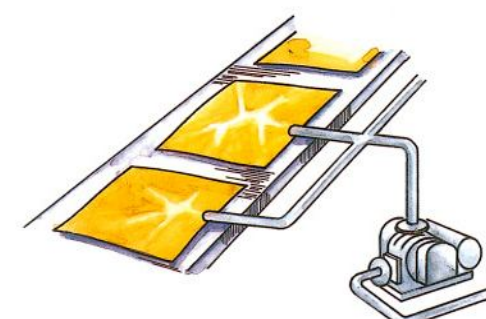

■ 食品真空包装
Vacuum Pack for Foods

>>SSR 性能表

>>TYPE SSR PERFORMANCE TABLE

0.75kW 1.1kW 1.5kW 2.2kW 3kW 4kW 5.5kW 7.5kW 11kW
15kW 18.5kW 22kW 30kW 37kW 45kW 55kW 75kW 90kW

型式 Type	口径 Bore	转速 rpm	排出压力(kgf/cm²) Discharge Pressure																				转速 rpm				
			0.10		0.15		0.20		0.25		0.30		0.35		0.40		0.45		0.50		0.55			0.60			
			9.8kPa		14.7kPa		19.6kPa		24.5kPa		29.4kPa		34.3kPa		39.2kPa		44.1kPa		49.0kPa		53.9kPa			58.8kPa			
			Qs	La	Qs	La	Qs	La	Qs	La	Qs	La	Qs	La	Qs	La	Qs	La	Qs	La	Qs	La		Qs	La		
SSR 125	125A	980	6.50	1.65	6.30	2.23	6.15	2.80	6.05	3.45	5.95	4.10	5.82	4.70	5.75	5.40	5.64	6.10	5.55	6.70	5.47	7.20	5.37	8.05	980		
		1050	6.95	1.90	6.78	2.54	6.63	3.15	6.51	3.85	6.42	4.53	6.30	5.20	6.22	5.95	6.11	6.65	6.03	7.30	5.95	7.90	5.85	8.75	1050		
		1200	8.00	2.50	7.80	3.20	7.65	3.92	7.55	4.70	7.45	5.50	7.34	6.28	7.25	7.10	7.15	7.90	7.00	8.65	6.98	9.40	6.90	10.25	1200		
		1310	8.75	2.90	8.55	3.65	8.40	4.50	8.29	5.35	8.19	6.20	8.09	7.05	8.00	7.90	7.90	8.80	7.82	9.65	7.74	10.05	7.64	11.40	1310		
		1390	9.30	3.20	9.10	4.00	8.95	4.90	8.84	5.80	8.74	6.70	8.63	7.60	8.54	8.50	8.45	9.45	8.37	10.35	8.28	11.25	8.20	12.20	1390		
		1450	9.72	3.45	9.50	4.25	9.35	5.20	9.25	6.15	9.15	7.10	9.05	8.05	8.95	9.00	8.85	9.90	8.77	10.90	8.70	11.80	8.60	12.80	1450		
		1530	10.27	3.80	10.07	4.70	9.90	5.65	9.80	6.65	9.70	7.65	9.60	8.60	9.50	9.60	9.40	10.60	9.33	11.60	9.25	12.60	9.15	13.60	1530		
		1630	10.96	4.30	10.75	5.20	10.57	6.25	10.47	7.25	10.37	8.35	10.27	9.35	10.17	10.35	10.08	11.35	10.01	12.40	9.93	13.50	9.85	14.60	1630		
		1750	11.78	4.90	11.55	5.80	11.38	6.95	11.29	7.95	11.18	9.18	11.09	10.20	10.99	11.26	10.91	12.33	10.83	13.38	10.75	14.70	10.66	15.80	1750		
		1850	12.48	5.40	12.25	6.36	12.05	7.55	11.97	8.57	11.85	9.88	11.70	10.94	11.66	12.02	11.58	13.12	11.50	14.20	11.42	15.60	11.34	16.85	1850		
SSR 150	150A	810	12.01	3.85	11.76	5.00	11.54	6.20	11.35	7.30	11.15	8.50	11.00	9.60	10.86	10.80	10.76	11.95	10.65	13.20	10.52	14.40	10.39	15.60	810		
		860	12.80	4.40	12.62	5.60	12.40	6.86	12.20	8.05	12.03	9.30	11.86	10.45	11.75	11.70	11.65	13.00	11.54	14.25	11.40	15.50	11.27	16.80	860		
		970	14.70	5.58	14.50	7.00	14.30	8.30	14.10	9.65	13.95	11.05	13.80	12.40	13.70	13.80	13.60	15.20	13.50	16.60	13.35	18.00	13.23	19.40	970		
		1110	17.08	7.00	16.90	8.60	16.70	10.15	16.52	11.70	16.37	13.10	16.25	14.80	16.15	16.50	16.05	18.00	15.95	19.60	15.85	21.20	15.70	22.80	1110		
		1180	18.25	7.80	18.10	9.45	17.92	11.10	17.73	12.70	17.59	14.40	17.47	16.00	17.37	17.80	17.27	19.40	17.17	21.10	17.07	22.80	16.97	24.40	1180		
		1240	19.27	8.45	19.10	10.20	18.95	11.90	18.77	13.60	18.63	15.40	18.53	17.07	18.43	18.90	18.33	20.70	18.23	22.40	18.13	24.20	18.03	25.80	1240		
		1400	22.00	10.20	21.83	12.10	21.70	14.00	21.55	15.95	21.40	17.90	21.30	19.90	21.20	21.90	21.15	23.85	21.05	25.80	20.97	27.90	20.87	29.70	1400		
		1520	23.93	11.65	23.80	13.80	23.68	15.90	23.52	18.00	23.40	20.15	23.30	22.30	23.21	24.60	23.13	26.70	23.04	28.90	22.95	31.20	22.82	33.30	1520		
		1620	25.42	13.40	25.30	15.60	25.15	18.00	25.00	20.40	24.86	22.60	24.75	25.00	24.68	27.40	24.58	29.65	24.48	32.05	24.40	34.40	24.27	36.90	1620		
		1730	27.05	15.30	26.92	17.60	26.77	20.20	26.61	22.90	26.48	25.30	26.35	27.90	26.27	30.40	26.17	33.00	26.08	35.55	26.00	38.00	25.87	40.80	1730		
SSR 175	200A	970	21.87	7.20	21.42	9.29	21.02	11.25	20.64	13.26	20.33	15.33	20.04	17.35	19.80	19.42	19.57	21.49	19.35	23.56	19.08	25.63	18.85	27.70	970		
		1110	25.43	8.91	25.01	11.28	24.61	13.59	24.25	15.90	23.94	18.05	23.67	20.52	23.44	23.00	23.21	25.25	22.98	27.62	22.77	29.99	22.51	32.35	1110		
		1180	27.20	9.87	26.80	12.83	26.42	14.79	26.06	17.19	25.76	19.71	25.49	22.11	25.25	24.73	25.02	27.14	24.98	29.65	24.58	32.17	24.37	34.57	1180		
		1240	28.73	10.65	28.31	13.25	27.96	15.80	27.61	18.35	27.30	21.00	27.06	23.52	26.82	26.21	26.59	28.86	26.37	31.41	26.15	34.07	25.94	36.51	1240		
		1400	32.81	12.75	32.40	15.60	32.07	18.46	31.74	21.37	31.43	24.28	31.18	27.24	30.95	30.21	30.77	33.12	30.54	36.02	30.35	39.10	30.14	41.84	1400		
		1520	35.76	14.47	35.39	17.67	35.07	20.81	34.73	23.95	34.45	27.14	34.20	30.34	33.98	33.70	33.77	36.84	33.55	40.09	33.35	43.45	33.11	46.59	1520		
		1620	38.10	16.51	37.74	19.81	37.39	23.34	37.06	26.86	36.76	30.17	36.50	33.69	36.29	37.22	36.06	40.58	35.84	44.10	35.65	47.57	35.40	51.21	1620		
		1730	40.67	18.72	40.29	22.19	39.94	26.00	39.60	29.91	39.31	33.50	39.04	37.30	38.82	41.00	38.59	44.80	38.38	48.55	38.18	52.19	37.94	56.22	1730		
		SSR 200	200A	810	31.77	8.05	31.19	11.28	30.52	14.65	29.98	17.60	29.55	20.68	29.21	23.83	28.89	26.94	28.57	29.99	28.22	33.16	27.91	36.05	27.63	39.05	810
				900	35.68	9.95	35.05	13.48	34.49	17.10	34.04	20.44	33.66	24.00	33.36	27.53	33.05	30.93	32.73	34.40	32.34	37.83	32.03	41.02	31.71	44.38	900
980	39.15			11.58	38.53	15.50	38.08	19.38	37.66	22.93	37.34	27.18	37.05	30.78	36.77	34.55	36.41	38.23	36.03	42.02	35.68	45.52	35.34	49.38	980		
1070	43.03			13.46	42.50	17.81	42.04	21.24	41.68	25.82	41.44	30.13	41.17	34.43	40.97	38.68	40.56	42.65	40.15	46.82	39.77	50.71	39.42	54.95	1070		
1150	46.50			15.18	46.04	19.95	45.55	23.71	45.31	28.13	45.07	32.71	44.85	37.26	44.60	42.02	44.21	46.62	43.78	50.98	43.42	55.09	43.06	59.74	1150		
1230	49.60			17.09	49.16	21.94	48.74	26.43	48.45	31.28	48.22	36.26	48.00	41.25	47.78	46.08	47.49	50.78	47.08	55.53	46.76	59.83	46.44	64.80	1230		
1310	52.67			19.65	52.22	24.34	51.86	29.20	51.57	34.28	51.38	39.66	51.18	44.88	50.99	50.18	50.69	55.09	50.40	59.96	50.10	64.53	49.83	69.72	1310		
1390	55.77			21.31	54.31	26.64	54.96	31.88	54.72	37.46	54.49	42.92	54.35	48.52	54.16	54.22	53.91	59.28	53.68	64.48	53.49	69.16	53.24	74.60	1390		
1480	59.20			23.80	58.83	28.96	58.46	34.37	58.24	40.42	58.02	46.58	57.89	52.36	57.76	58.19	57.57	63.62	57.37	68.98	57.22	74.22	57.08	80.18	1480		

>>SSR-V 真空性能表

>>TYPE SSR-V VACUUM PERFORMANCE TABLE

0.75kW 1.1kW 1.5kW 2.2kW 3kW 4kW 5.5kW 7.5kW 11kW
15kW 18.5kW 22kW 30kW 37kW 45kW 55kW 75kW

Qs: 各真空度下的风量(m³/min)
Vacuum Volume at each Discharge pressure(m³/min)
La: 所需动力(kW)
Required electric power(kW)

型式 Type	口径 Bore	真空度 Vacuum pressure	-100mmHg		-150mmHg		-200mmHg		-250mmHg		-300mmHg	
			-1360mmAq		-2040mmAq		-2720mmAq		-3400mmAq		-4080mmAq	
			Qs	La	Qs	La	Qs	La	Qs	La	Qs	La
SSR-50V	吸入口径 5K-40A 吐出口径 1.0MPa-50A	1100	1.12	0.36	1.03	0.55	0.94	0.74	0.86	0.93		
		1230	1.29	0.47	1.20	0.67	1.10	0.88	1.02	1.08		
		1350	1.45	0.58	1.36	0.80	1.26	1.02	1.16	1.24		
		1470	1.62	0.74	1.54	0.96	1.45	1.18	1.35	1.40	1.25	1.62
		1560	1.76	0.86	1.69	1.09	1.60	1.31	1.50	1.54	1.37	1.76
		1660	1.88	0.93	1.81	1.17	1.71	1.41	1.61	1.66	1.48	1.90
		1750	1.99	0.99	1.92	1.27	1.82	1.50	1.71	1.76	1.58	2.02
		1850	2.12	1.13	2.05	1.39	1.95	1.65	1.84	1.91	1.71	2.17
		1960	2.27	1.28	2.20	1.55	2.10	1.81	1.99	2.08	1.90	2.34
		2120	2.46	1.56	2.38	1.84	2.27	2.21	2.15	2.40	2.02	2.67
SSR-65V	吸入口径 5K-50A 吐出口径 1.0MPa-65A	1100	1.57	0.75	1.43	0.98	1.30	1.21	1.16	1.45		
		1240	1.83	0.84	1.69	1.09	1.54	1.35	1.40	1.61		
		1360	2.08	0.95	1.93	1.24	1.78	1.52	1.64	1.81		
		1460	2.27	1.05	2.13	1.35	1.99	1.65	1.84	1.96	1.70	2.26
		1550	2.47	1.13	2.32	1.45	2.1					

>> SSR 外形尺寸图

>> TYPE SSR OUTLINE DIMENSIONS

★标准附属品

- 通用底座
- 皮带罩
- 风机皮带轮、电机带轮、V形皮带
- 吸入消声器（带过滤器）
- 安全阀
- 压力表
- 润滑油
- 地脚螺栓

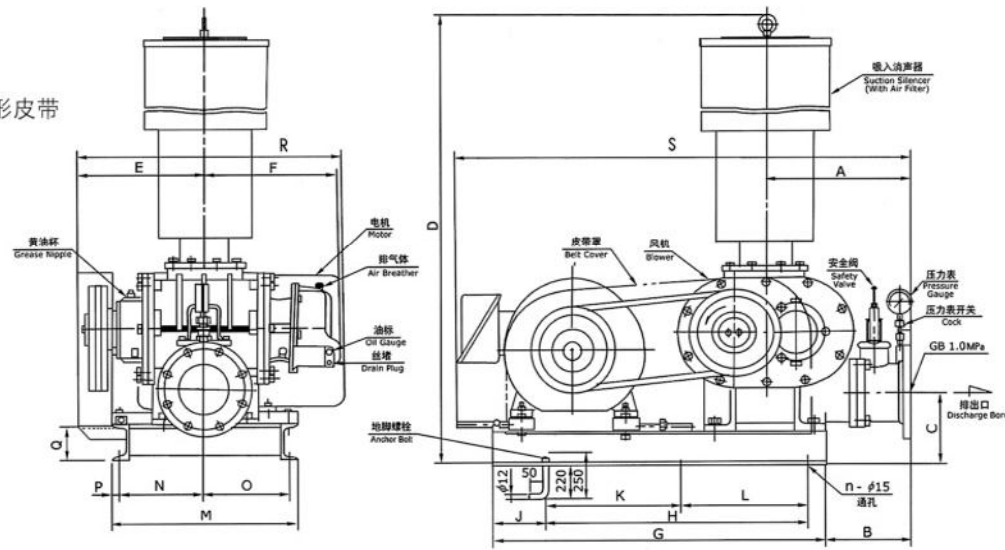

单位/mm Unit/mm

型式 Type	记号 Mark	口径 Bore	A	B	C	D	E	F	G	H	J	K
SSR-50	50A	50A	230	130	125	895	185	179	560	410	100	—
SSR-65	65A	65A	230	130	135	970	205	202	600	450	100	—
SSR-80	80A	80A	280	170	150	1130	220	225	650	500	100	—
SSR-100	100A	100A	280	155	160	1255	260	265	730	580	100	—
SSR-125	125A	125A	355	205	190	1515	295	294	860	700	110	350
SSR-150	150A	150A	400	235	210	1730	370	377	960	750	160	400
SSR-175	200A	200A	520	355	230	1775	465	457	1100	840	160	420
SSR-200	200A	200A	591	378	256	2210	525	550	1280	1000	180	500
型式 Type	记号 Mark	口径 Bore	L	M	N	O	P	Q	n	R	S	重量(kg) Weight
SSR-50	50A	50A	—	300	115	155	15	80	4	450	730	70
SSR-65	65A	65A	—	340	135	175	15	80	4	500	780	81
SSR-80	80A	80A	—	360	130	200	15	80	4	530	860	123
SSR-100	100A	100A	—	470	170	270	15	80	4	600	930	157
SSR-125	125A	125A	350	470	185	255	15	100	6	710	1230	235
SSR-150	150A	150A	350	590	250	300	20	100	6	860	1335	394
SSR-175	200A	200A	420	720	325	355	20	100	6	1045	1600	495
SSR-200	200A	200A	500	755	360	345	25	126	6	1080	1765	860

注) 重量中不包括电机重量

Note: The weights given do not include the motor.

>> SSR 直联式 外形尺寸图

>> TYPE SSR DIRECT COUPLING OUTLINE DIMENSIONS

★标准附属品

- 通用底座
- 皮带罩
- 风机皮带轮、电机带轮、V形皮带
- 吸入消声器（带过滤器）
- 安全阀
- 压力表
- 润滑油
- 地脚螺栓

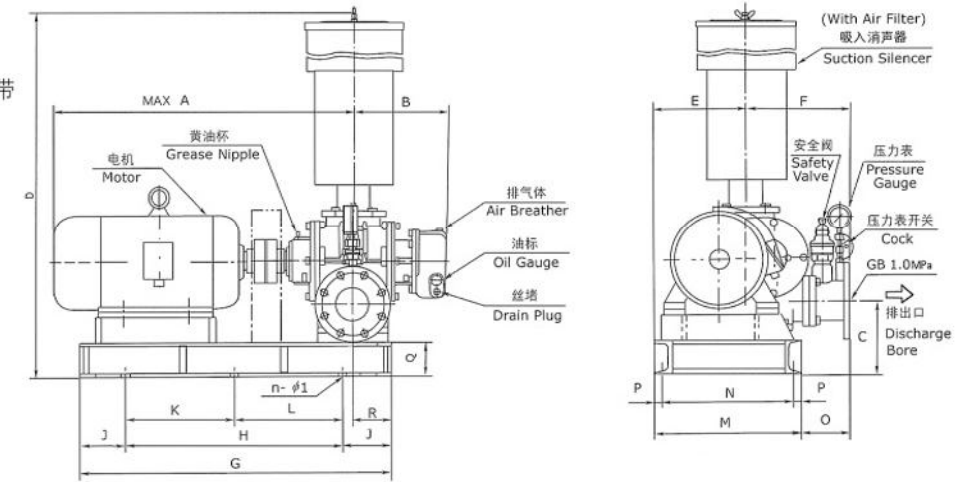

单位/mm Unit/mm

型式 Type	记号 Mark	口径 Bore	A	B	C	D	E	F	G	H	J	
SSR-50	50A	50A	570	179	135	895	152	230	540	420	60	
SSR-65	65A	65A	610	202	145	970	192	230	600	440	80	
SSR-80	80A	80A	700	225	165	1130	217	280	650	500	75	
SSR-100	100A	100A	900	265	175	1255	234	280	850	630	110	
SSR-125	125A	125A	945	294	205	1525	260	345	920	710	105	
SSR-150	150A	150A	1155	377	225	1745	305	385	1150	950	100	
SSR-175	200A	200A	1300	457	245	1765	305	505	1330	1030	150	
SSR-200	200A	200A	1570	550	276	2230	405	593	1600	1300	150	
型式 Type	记号 Mark	口径 Bore	K	L	M	N	O	P	Q	R	n-φ1	重量(kg) Weight
SSR-50	50A	50A	—	—	260	220	122	20	80	60	4-φ14	72
SSR-65	65A	65A	—	—	300	260	122	20	80	80	4-φ14	84
SSR-80	80A	80A	—	—	370	330	147	20	80	75	4-φ19	132
SSR-100	100A	100A	—	—	400	360	114	20	80	110	4-φ19	168
SSR-125	125A	125A	355	355	430	390	175	20	100	105	6-φ19	245
SSR-150	150A	150A	475	475	500	455	190	22.5	100	165	6-φ19	408
SSR-175	200A	200A	515	515	500	455	310	22.5	100	240	6-φ19	505
SSR-200	200A	200A	650	650	650	605	348	22.5	126	240	6-φ19	900

>> SSR 噪音值
>> TYPE SSR NOISE LEVEL

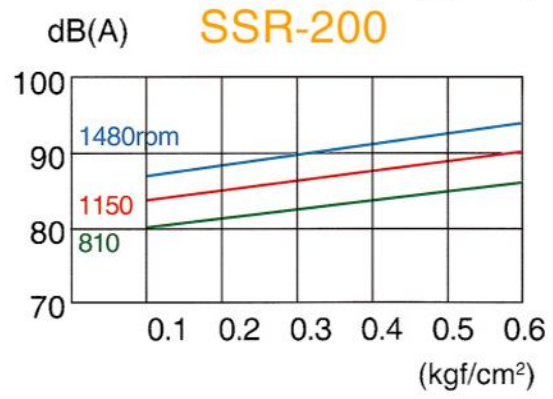
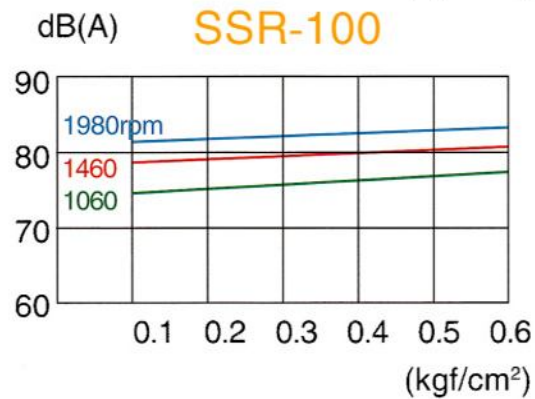
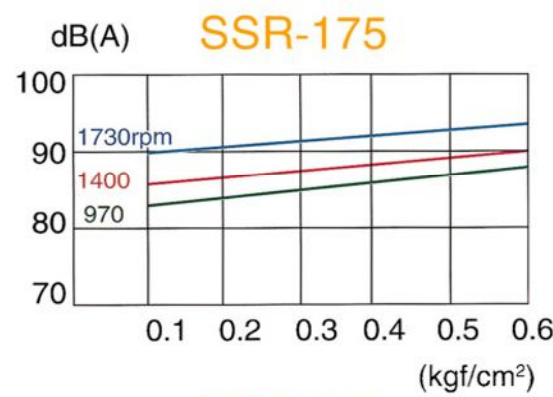
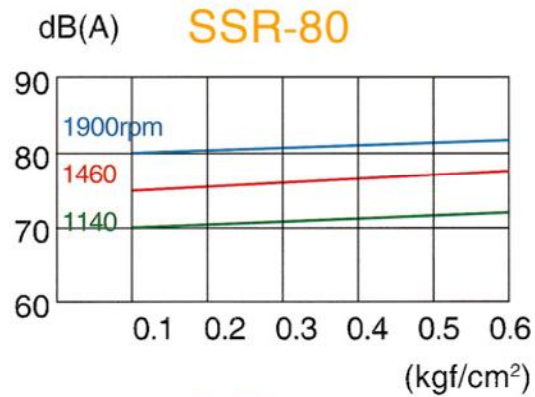
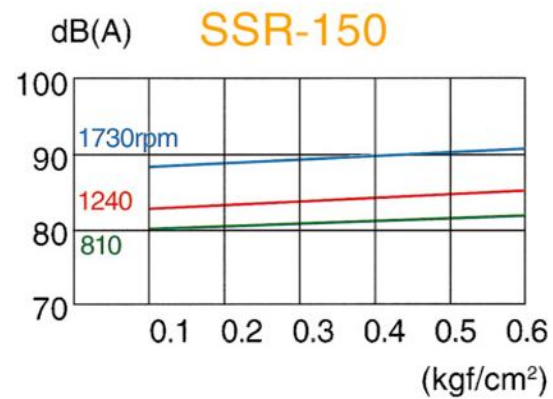
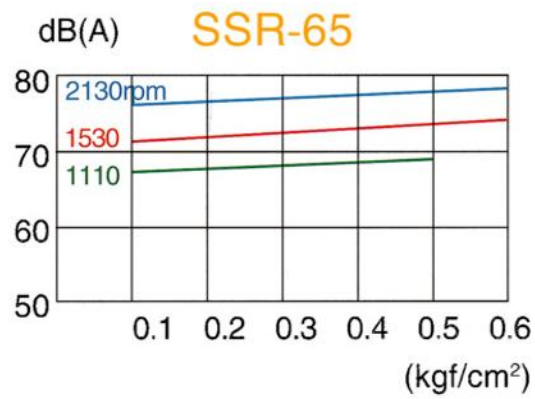
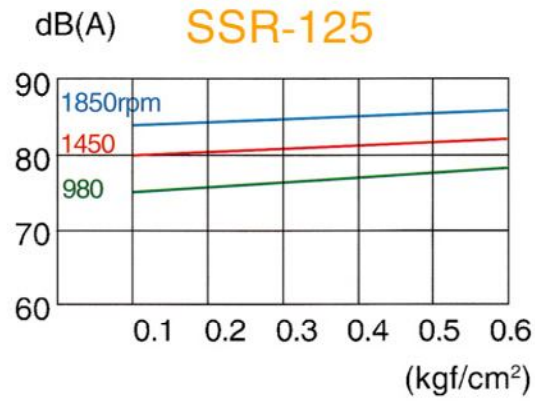
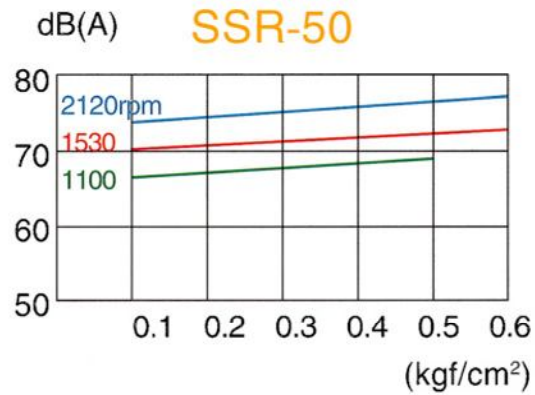

● 噪音值 dB(A) 机侧 1.0m
NOISE LEVEL dB(A) Machine Side 1.0m
注: 上述数据是在本社测定的数据
Note: There values are based on the measurements taken in our shop

SSR-HB高压型 性能表
TYPE SSR-HB PERFORMANCE TABLE

Qs: 进风状态风量 (m³/min)
Suction-phase Air Volume(m³/min)
La: 所需动力 (kW)
Required electric power(kW)

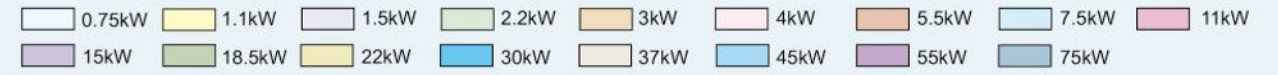

型式 Type	口径 Bore	转速 rpm	排出压力(kgf/cm²) Discharge Pressure																转速 rpm	
			0.30		0.40		0.50		0.60		0.65		0.70		0.75		0.80			
			Qs	La	Qs	La	Qs	La	Qs	La	Qs	La	Qs	La	Qs	La	Qs	La		
SSR 50H	50A	1530	1.52	1.34	1.42	1.69	1.34	2.03	1.27	2.38	1.24	2.56								1530
		1640	1.67	1.47	1.58	1.84	1.50	2.21	1.42	2.58	1.39	2.77								1640
		1730	1.80	1.57	1.70	1.96	1.62	2.36	1.55	2.75	1.51	2.95								1730
		1840	1.95	1.71	1.86	2.12	1.78	2.54	1.70	2.96	1.66	3.17	1.62	3.38						1840
		1950	2.11	1.85	2.01	2.29	1.93	2.73	1.85	3.18	1.81	3.41	1.77	3.63						1950
		2120	2.34	2.07	2.25	2.55	2.17	3.03	2.09	3.52	2.05	3.76	2.01	3.99	1.97	4.20				
SSR 65H	65A	1530	2.14	1.72	2.02	2.25	1.90	2.72	1.79	3.20										1530
		1640	2.36	1.89	2.24	2.46	2.12	2.95	2.01	3.46	1.96	3.86								1640
		1740	2.56	2.04	2.44	2.64	2.32	3.16	2.21	3.70	2.16	4.11								1740
		1820	2.72	2.16	2.60	2.79	2.48	3.33	2.37	3.90	2.32	4.37	2.26	4.66						1820
		1940	2.96	2.35	2.83	3.02	2.71	3.59	2.61	4.20	2.56	4.70	2.50	5.01						1940
		2130	3.33	2.65	3.21	3.35	3.09	4.00	2.99	4.66	2.94	5.20	2.88	5.55	2.83	5.88				
SSR 80H	80A	1460	3.65	3.11	3.49	3.88	3.34	4.64	3.20	5.40	3.13	5.78	3.06	6.16						1460
		1560	3.98	3.35	3.82	4.17	3.67	4.99	3.53	5.79	3.46	6.19	3.39	6.59	3.32	6.99				1560
		1650	4.28	3.56	4.12	4.44	3.96	5.30	3.82	6.15	3.75	6.58	3.68	7.00	3.61	7.43				1650
		1730	4.55	3.76	4.39	4.67	4.23	5.57	4.09	6.47	4.02	6.92	3.95	7.37	3.88	7.82	3.81	8.27		1730
		1820	4.84	3.97	4.68	4.94	4.52	5.88	4.38	6.82	4.31	7.29	4.24	7.76	4.17	8.23	4.10	8.70		1820
		1900	5.11	4.16	4.95	5.17	4.79	6.16	4.65	7.40	4.58	7.63	4.51	8.12	4.44	8.61	4.37	9.10		1900
SSR 100H	100A	1310	5.18	4.05	4.95	5.18	4.74	6.30	4.55	7.48	4.45	8.17	4.38	8.73						1310
		1460	6.00	4.62	5.78	5.87	5.58	7.10	5.39	8.45	5.30	9.21	5.20	9.83	5.11	10.46				1460
		1540	6.40	4.98	6.19	6.30	5.99	7.61	5.81	9.00	5.72	9.78	5.62	10.44	5.53	11.10				1540
		1680	7.13	5.62	6.92	7.08	6.73	8.50	6.55	10.03	6.46	10.79	6.37	11.51	6.28	12.23	6.19	12.95		1680
		1780	7.62	6.10	7.42	7.63	7.23	9.15	7.06	10.71	6.98	11.55	6.89	12.32	6.81	13.09	6.72	13.86		1780
		1880	8.15	6.55	7.95	8.18	7.77	9.80	7.60	11.42	7.52	12.28	7.43	13.08	7.35	13.89	7.26	14.69		1880
Type	Bore	rpm	29.4kPa		39.2kPa		49kPa		58.8kPa		63.7kPa		68.6kPa		73.5kPa		78.4kPa		rpm	
			0.30		0.40		0.50		0.60		0.65		0.70		0.75		0.80			
			排出压力(kgf/cm²) Discharge Pressure																	
			Qs	La	Qs	La	Qs	La	Qs	La	Qs	La	Qs	La	Qs	La	Qs	La		